

I'm not robot!

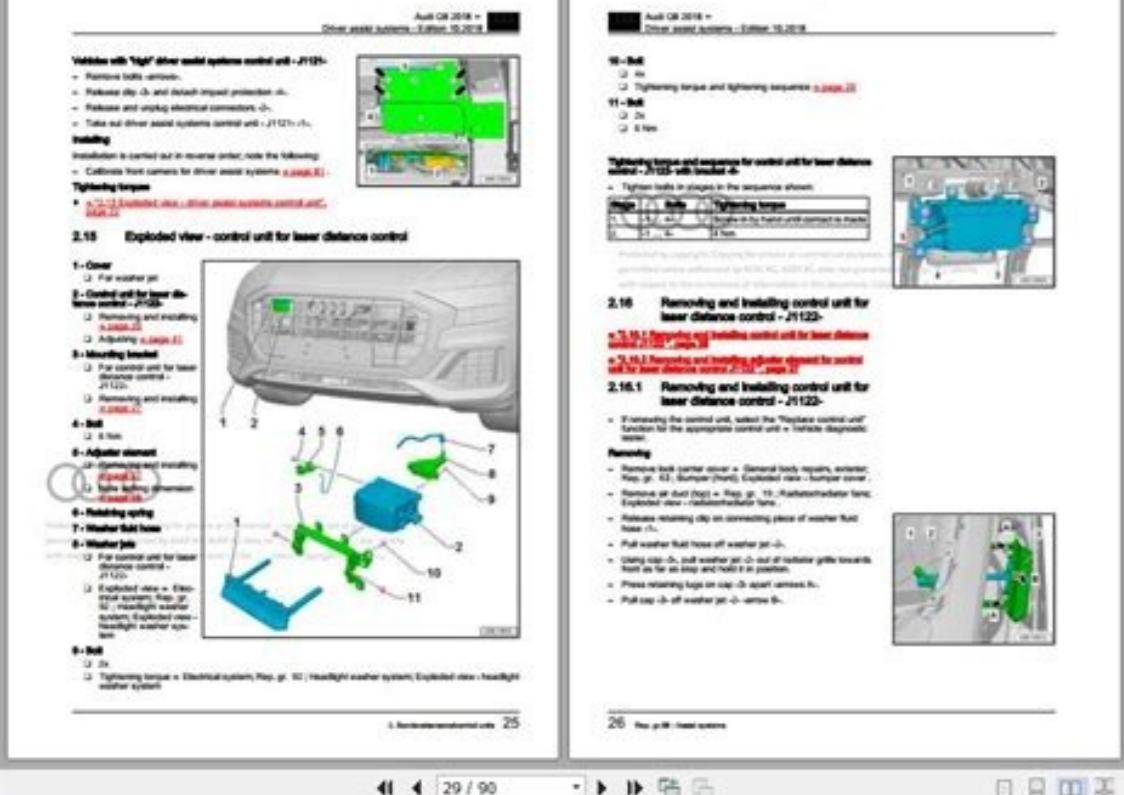

Clutch Housing

Inspect and Repair Clutch Pedal and Linkage—Isolated Open Operator Station and Cab Tractors (PowrReverser™ Transmissions)

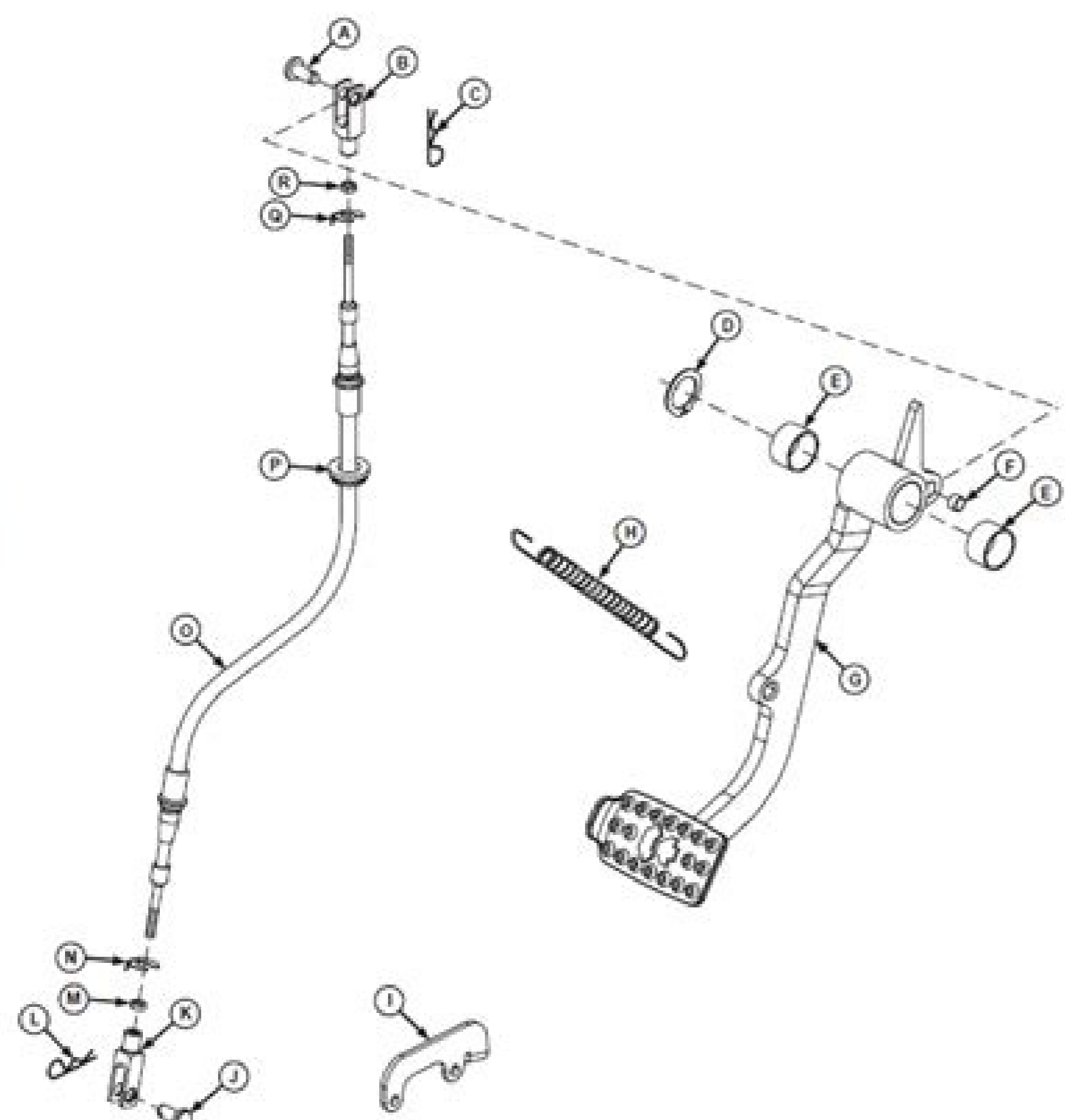

- A—Clevis Pin
- B—Yoke
- C—Spring Pin
- D—Snap Ring
- E—Bushing (2 used)
- F—Bushing
- G—Clutch Pedal
- H—Extension Spring
- I—Bracket
- J—Clevis Pin
- K—Yoke
- L—Spring Pin
- M—Nut
- N—Retaining Clip
- O—Clutch Cable
- P—Grommet
- Q—Retaining Clip
- R—Nut

1. Remove left dash panel.

TM2048 (15MAR02)

50-05-32

5220, 5320, 5420, and 5520 Tractor Repair

www.epcatalogs.com

